

SIS/IEP Data Warehouse Refresh Process

SUNDAY

Term Ends

- Data Warehouse SIS/IEP Current Object setup begins for next term
- Email Notification to users

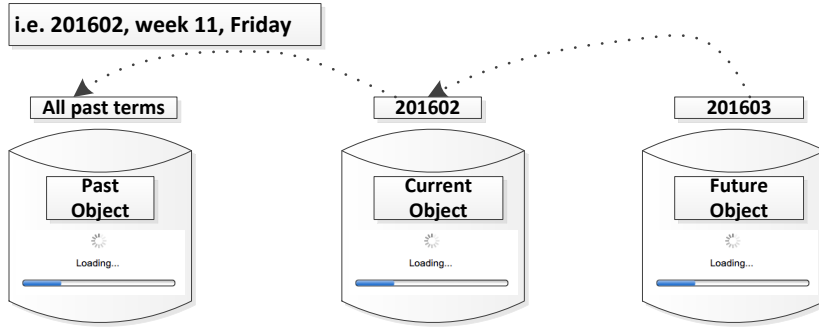

MONDAY

Grade Collection Begins

- Missing Grade Notifications go to department contacts
- Grades are rolled once at noon
- Data Warehouse Current and Future Object movement done.

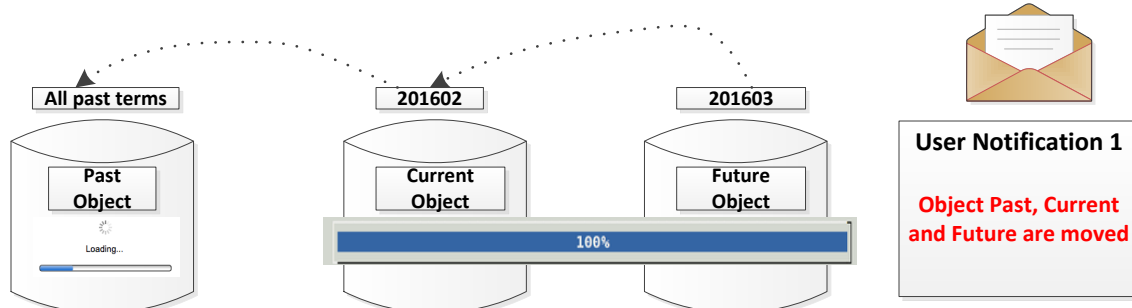

TUESDAY

Grade Collection ends

- Grade Processing Begins

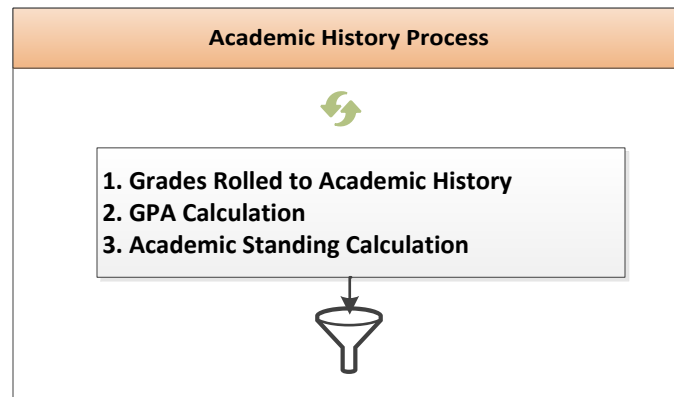

WEDNESDAY

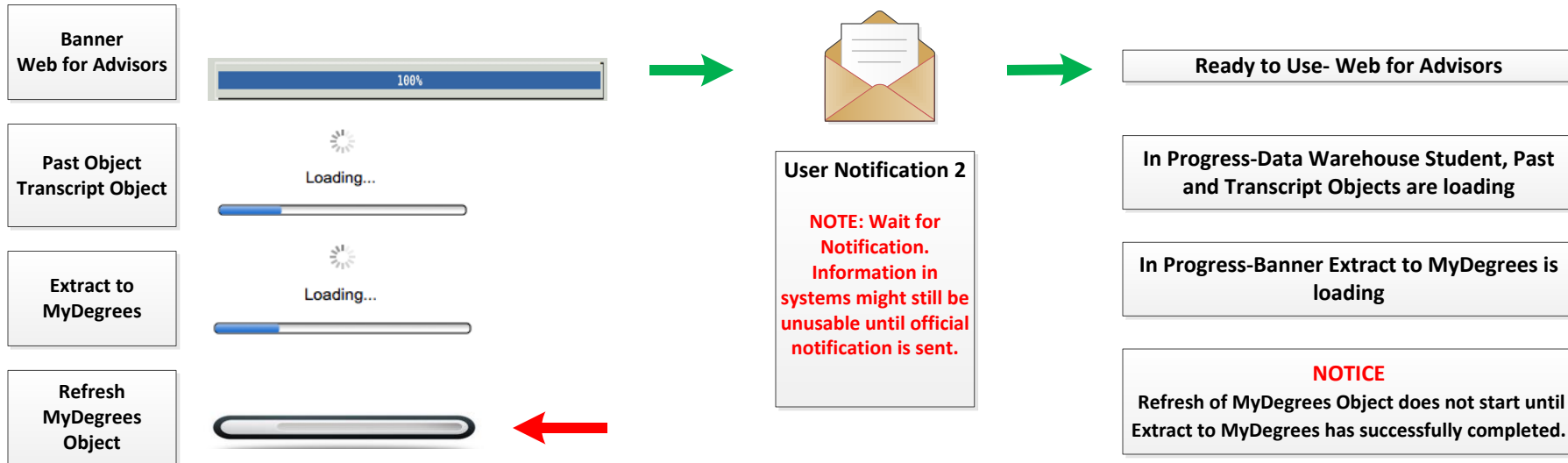

THURSDAY

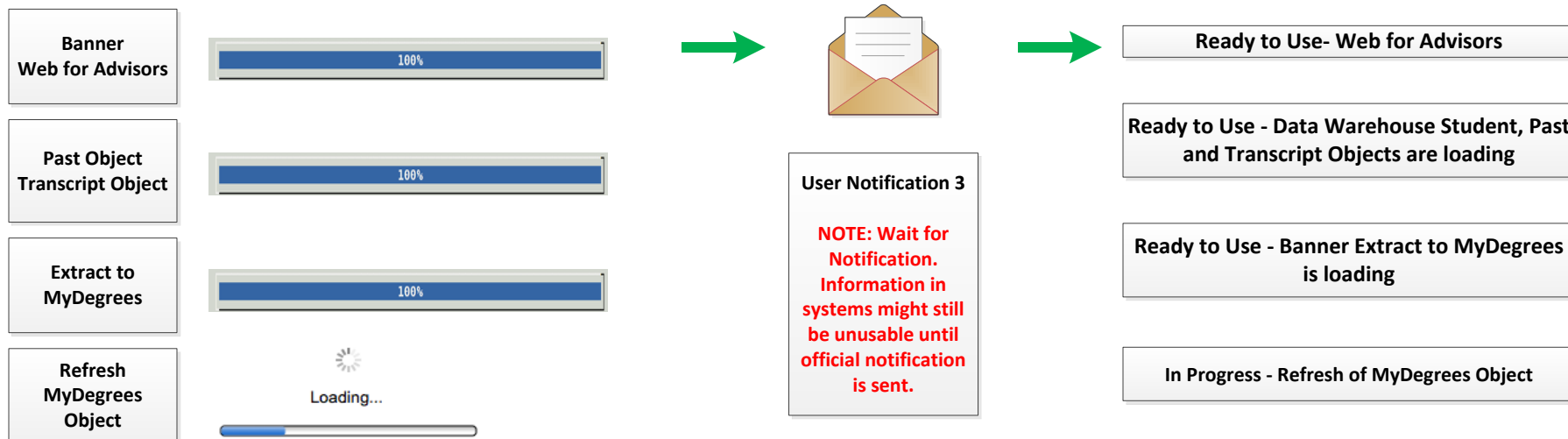

FRIDAY

